

## Topic Skills Practice Cover Sheet

<b>Unit Name:</b>	UEEEL0012 Install low voltage wiring, appliances, switchgear and associated accessories
<b>Topic Title:</b>	Underground Cabling

<b>Skill Practice Number:</b>	7.1
<b>Skill Practice Name:</b>	Identify Underground Services

<b>Student Name:</b>	
<b>Student ID:</b>	
<b>College/Campus:</b>	
<b>Group:</b>	

Results	
<b>Planning:</b>	
<b>Carryout:</b>	
<b>Completion:</b>	
<b>Overall Results:</b>	
<b>Comments:</b>	

# Topic Skills Practice 7.1

UEEEL0012 Install low voltage wiring, appliances, switchgear and associated accessories

## Topic 7. Underground Cabling

### Skills Practice 7.1: Identify Underground Services

#### Task:

To obtain information relating to the presence of existing underground services at a given location, and interpret plans to determine the suitability of proposed underground wiring.

#### Objectives:

At the completion of this skills practice, you should be able to:

- Obtain plans of existing underground services.
- Interpret plans to identify the locations of existing underground services.
- Determine the suitability of underground cable routes.

# Topic Skills Practice 7.1

## 1. Planning the Skills Practice

### 1.1 Standards and Equipment

1.1.1 To complete this skills practice, your teacher/trainer will provide a proposed underground cable route at your location. You will need to obtain the following resources and equipment:

- Plans of existing underground infrastructure at your location
- AS/NZS 3000:2018 Wiring Rules
- Pens/pencils

## 2. Carrying Out the Skills Practice

### 2.1 Identify Existing Underground Services

2.1.1 On the diagram below, identify the existing underground services and the minimum clearances required to a proposed LV underground (UG) service. Then determine a suitable UG cable route from the point of supply (POS) at the top of the service pole, to the main switchboard (MSB). Indicate the cable route on the diagram and record details of the wiring system in the table provided at the top of the following page.

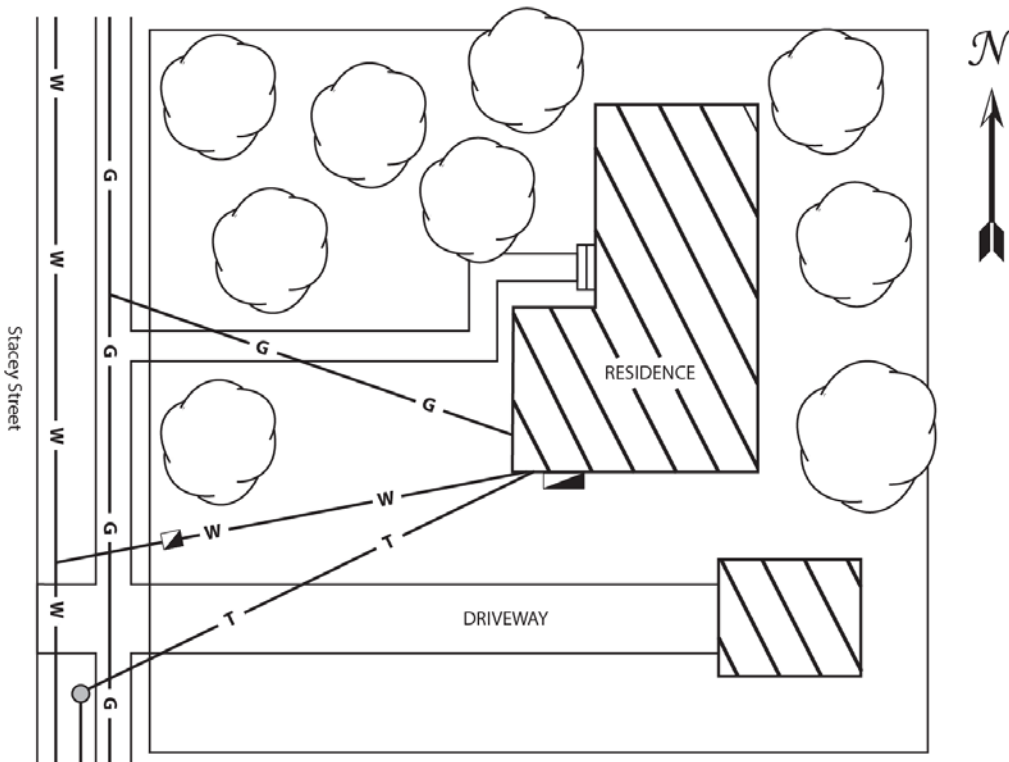

Other Service: \_\_\_\_\_

Minimum Clearance: \_\_\_\_\_

Other Service: \_\_\_\_\_



Minimum Clearance: \_\_\_\_\_

Other Service: \_\_\_\_\_

Minimum Clearance: \_\_\_\_\_

# Topic Skills Practice 7.1

Underground Wiring System	
<b>Description:</b>	
Applicable Requirements/Rules	
<b>Wiring System Category:</b>	
<b>Depth of Cover:</b>	
<b>AS/NZS 3000 Clause(s):</b>	
<b>Local Service Rules Clause(s):</b>	

	 Have your teacher/trainer check your answers <i>Feedback</i>	Teacher/Trainer Initials and Date <hr style="width: 100%;"/>	
---	---	--	---

## 2.2 Obtain Information on Underground Services



2.2.1 Your teacher/trainer will provide you with a proposed underground cable route at your location. In the space provided below, draw a neat sketch to show a bird's eye view of the proposed installation:

Proposed Excavation For Underground Wiring

# Topic Skills Practice 7.1

2.2.2 As directed by your teacher/trainer, obtain plans of existing underground services for the proposed excavation area.

2.2.3 Use the plans of the area to identify any existing services that are located in the vicinity of the proposed excavation area, and indicate them on your sketch on the previous page.

	 <b>Feedback</b>	Have your teacher/trainer check your work	Teacher/Trainer Initials and Date	

## 3. Completing the Skills Practice

### 3.1 Skills Practice Review Questions

3.1.1 Complete the following questions after you have successfully completed section 2 of the skills practice.

1. What types of existing services are located in the proposed area?

---

---

---

2. Did the locations of underground services in your area affect the initial planned excavation works? If so, explain how.

---

---

---

---

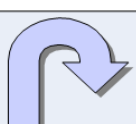
	 <b>Feedback</b>	Have your teacher/trainer check your answers	Teacher/Trainer Initials and Date	